

Bommer Industries Inc.  
 19810 Highway 176  
 P.O. Box 187  
 Landrum SC 29356

# TEMPLATE HINGES

HALF MORTISE  
 SIZE 4.5 INCHES  
 (045)  
 DRAWING NOT TO SCALE

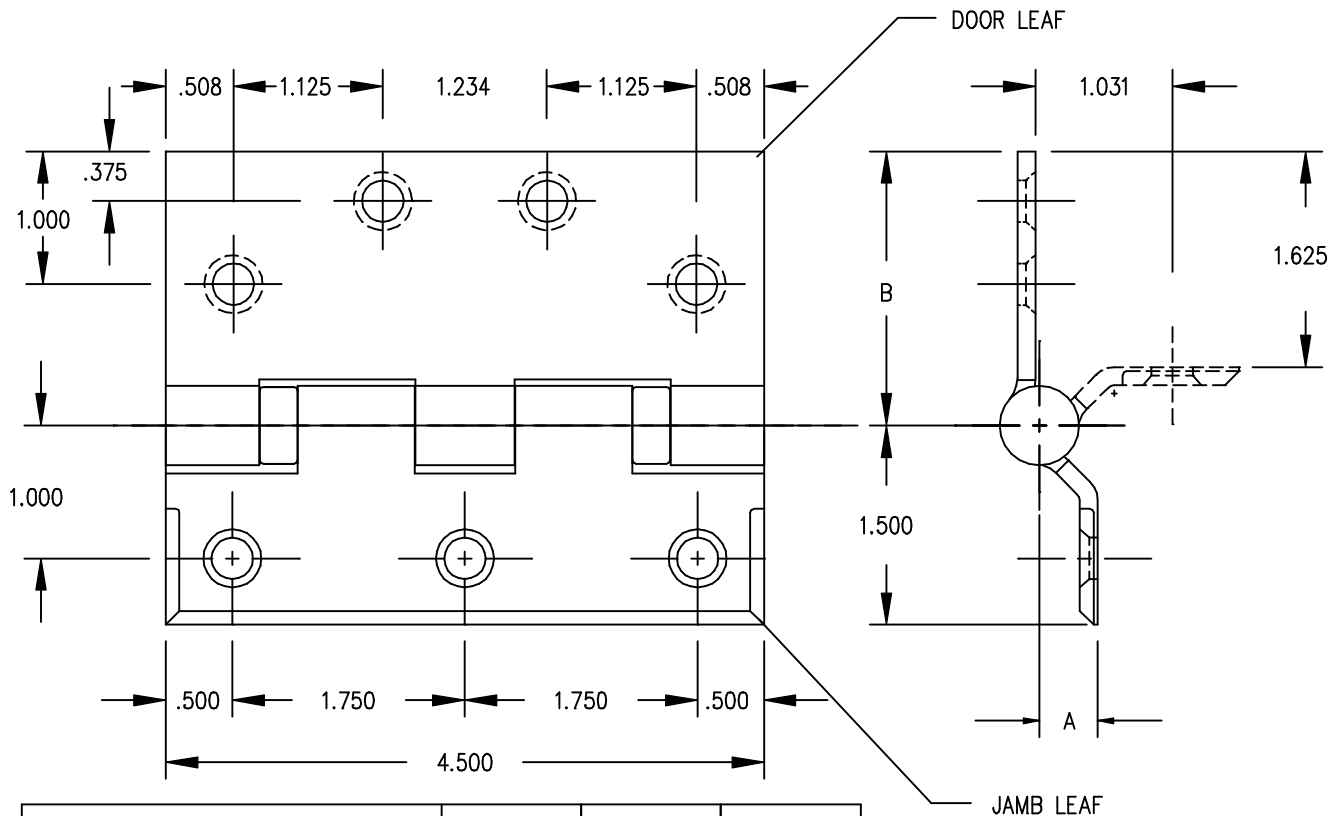

| CATALOG NUMBER |                        |                        | GAUGE OF METAL | A DIM. | B DIM. |
|----------------|------------------------|------------------------|----------------|--------|--------|
| STEEL HINGES   | BRASS OR BRONZE HINGES | STAINLESS STEEL HINGES |                |        |        |
| 5100           | 5101                   | 5102                   | .134           | .438   | 2.062  |
| BB5100         | BB5101                 | BB5102                 | .134           | .438   | 2.062  |
| 8100           | 8101                   | 8102                   | .134           | .438   | 2.062  |
| LB8100         | LB8101                 | LB8102                 | .134           | .438   | 2.062  |

MACHINE SCREW SIZE:  
 DOOR LEAF - 1/2 X 12-24 F.H.  
 JAMB LEAF - 1/2 X 12-24 O.H.

TEMPLATE NO. 5100-045-T  
 REV./31 MAY 95